



February 4, 2025

Ms. Sarah Hensley, Director of Community Development  
**City of Keller**  
1100 Bear Creek Parkway,  
Keller, TX 76248

**RE: Landscape Systems- Rezoning Request**

Sarah,

Please accept the attached application and exhibits for the completion of a rezoning to Planned Development for the existing Landscape Systems property and facilities at 1823 Keller Pkwy, Keller, TX 76248.

The primary request is to codify and tidy-up the zoning of an existing, long-time, successful Keller business; this is not a request for a significant change in uses or intensity. Much work with the city, and the adjacent neighbors has been accomplished, so hopefully everyone will be comfortable with the request. That said, we would be happy to respond to any comments or questions staff or city officials may have. We look forward to working with you for the successful completion of this zoning.

Please contact me with any comments or questions, or if you need any additional information from us.

Best Regards,  
SAGE GROUP, INC.

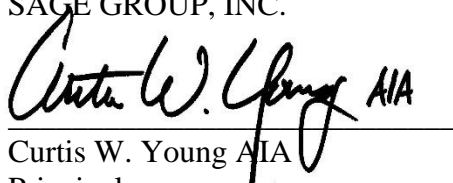

Curtis W. Young AIA  
Principal





















USAR  
GUANTES

SOLAMENTE PONER  
COMBUSTIBLE EN  
CONTENEDORES  
AUTORIZADOS

APA  
A  
CO

FU

GLP TRANSIT LLC  
USDOT 3985642  
PUCO 653435

WEAR  
GLOVES  
TURN OFF  
THE ENGINE  
WHEN FUELING  
ONLY USE  
APPROVED  
EQUIPMENT

HEAT LAKES  
PETROLEUM

COMBUSTIBLE  
NO SMOKING

1993  
3







252-1,847 USG | 955-6,991 L

# FUELCUBE



## EFFICIENT, ONSITE FUEL STORAGE

Avoid unwanted downtime and increased operational efficiency with the FuelCube, our most compact and economical stationary fuel tank. Field-proven for onsite supply and refueling in construction and distribution, the FuelCube guarantees a consistent, environmentally safe source of fuel.



## BENEFITS



### SAVES SPACE

Easily stackable when empty (up to 2 high) to save space in your yard.



### 110% CONTAINED

Built-in double-walled containment eliminates the need for spill pans or basins.



### READY TO MOVE

Four-way fork pockets for quick and easy maneuvering and mobility when empty.



### TURNKEY

Built for your fueling needs with pre-installed accessories. Arrives onsite ready to go.



### SECURE

Lockable equipment cabinet keeps fuel, ports and equipment safe.



### GUARANTEED

Industry leading 8-year tank warranty. We've got you covered.



## APPLICATION USES

- Onsite fuel supply
- Fleet refueling
- Remote & mega jobsites
- Extended runtime
  - Generator
  - Pump
  - Heater



## MODELS & SPECIFICATIONS

	FCP250	FCP500	FCP1000	FCP1800
BRIM FILL	252 USG / 955 L	544 USG / 2,058 L	1,018 USG / 3,855 L	1,847 USG / 6,991 L
95% SAFE FILL	240 USG / 907 L	516 USG / 1,955 L	967 USG / 3,662 L	1,754 USG / 6,641 L
WEIGHT (EMPTY)	875 lbs / 397 kg	1,422 lbs / 645 kg	2,372 lbs / 1,076 kg	3,728 lbs / 1,691 kg
WEIGHT (FULL)	2,875 lbs / 1,304 kg	5,959 lbs / 2,703 kg	10,871 lbs / 4,931 kg	19,141 lbs / 8,682 kg
DIMENSIONS (L x W x H)	46 x 46 x 51 in 1,164 x 1,164 x 1,288 mm	87 x 46 x 51 in 2,212 x 1,166 x 1,288 mm	87 x 91 x 46 in 2,220 x 2,320 x 1,166 mm	156 x 87 x 46 in 3,969 x 2,212 x 1,166 mm

## TANK APPROVALS & STANDARDS

### STATIONARY



UL142



CAN/ULC-S601



NFPA 30



**Note:** This drawing may not be reproduced in any form without the written permission of Hughes Tank Company, Inc. Customer is responsible for verifying correctness of size, location of fittings, accessories and coatings shown on this drawing. Hughes Tank Company, Inc. shall be responsible only for the items indicated in this fabrication drawing unless otherwise noted.

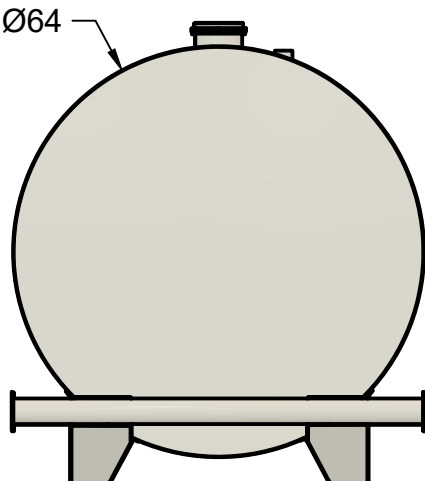
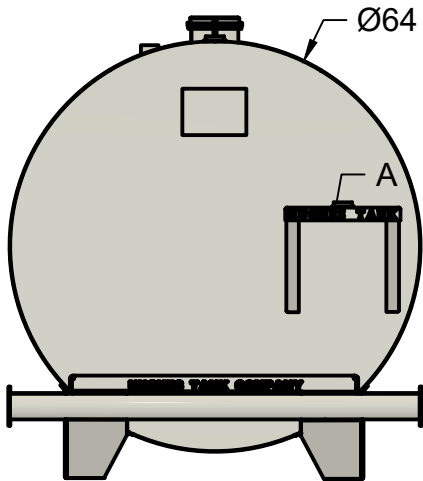
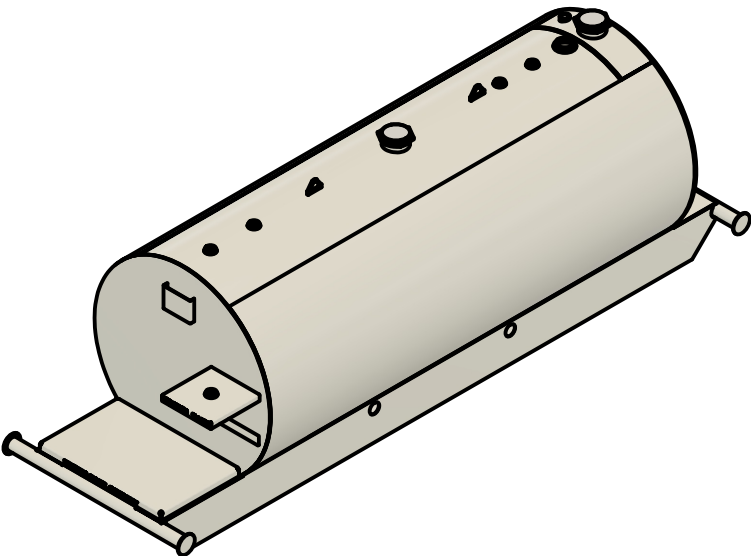
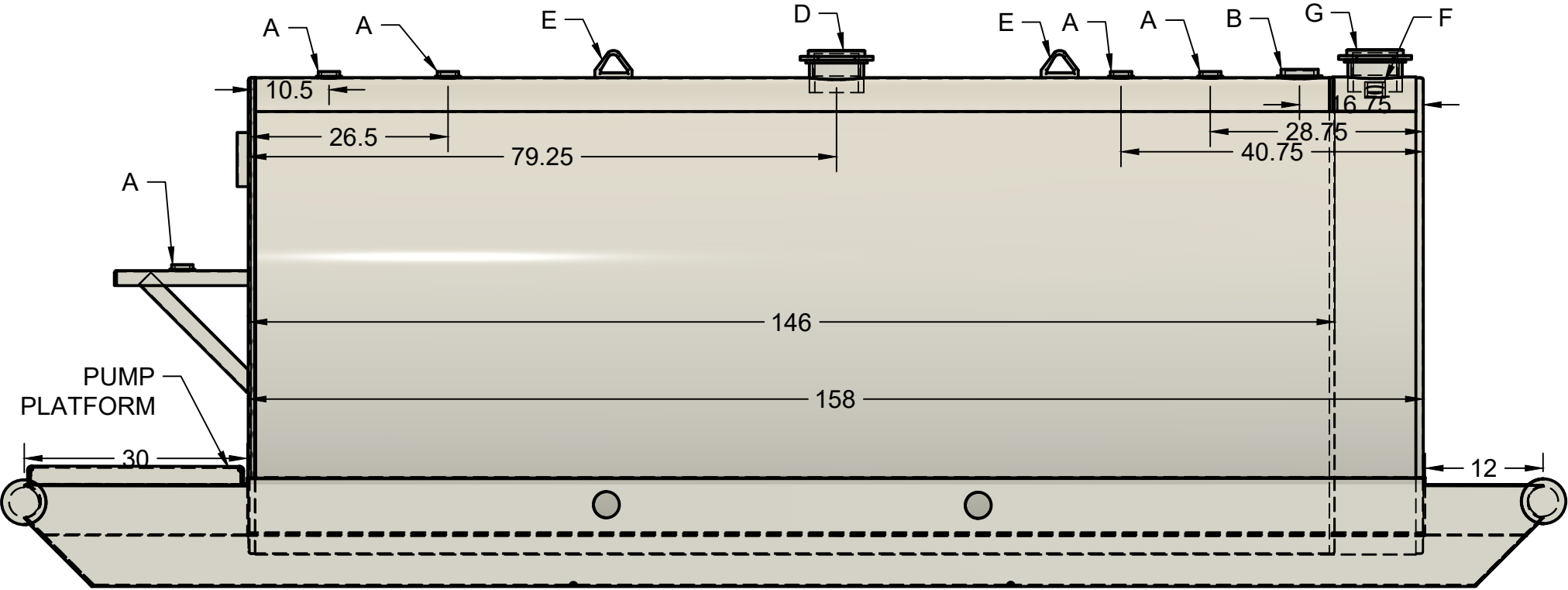

- Inspection: Hughes Tank Company
  - Material: A36 Mild Carbon Steel
  - Internal: Surface prep - Clean of Debris
  - External: Surface prep - SSPC-SP6 (commercial blast)
  - External: (WHITE) Enviroastic 940 LV Polyurthane
- Test: Inner tank: 5PSIG Hydrostatic  
Outer tank: Hydrostatic  
Pressure Test: 3-5 PSI
- Lables: - UL 142
- This drawing may contain **CONFIDENTIAL** information and is intended **ONLY** for the use of the specific individual to which it is addressed.

CUSTOMER APROVAL

SIGNATURE: \_\_\_\_\_

DATE: \_\_\_\_\_

A	Coupling	2"	2" threaded fitting	Primary
B	Coupling	4"	4" threaded fitting	Primary
C	Coupling	6"	6" threaded fitting	Primary
D	Emergency Vent	6"	6"emergency vent	Primary
E	Lifting Lug	Med.	Medium lifting lug	Secondary
F	Interstitial	2"	2" interstitial fitting	Secondary
G	Emergency Vent	6"	6"emergency vent	Secondary
H	Manhole	18"	18" manhole	Primary

**Note:** At no time shall the pressure in the secondary tank exceed the pressure in the primary tank.

APPROVED Bobby Hughes  
CHECKED Paige Hughes  
DRAWN James Smith

CUSTOMER: **REEDER**

PROJECT: **2K UL DWW PIPE SKID**

WEIGHT 3,500 LBS	REV	SHEET 1/1
------------------	-----	-----------



**HUGHES  
TANK  
COMPANY**

HUGHES TANK COMPANY

O: (972) - 366 - 8684

2900 N. FM 157  
VENUS, TX 76084

- DESIGN: Fabricated per UL 142 specifications double wall construction.
- Air test are no less than 3 PSI and no more than 5 PSI.
  - Primary tank to be tested alone. Secondary tank to be pressure tested with primary tank. This shall be accomplished by bleeding air from the primary tank to the secondary tank.



**Note:** This drawing may not be reproduced in any form without the written permission of Hughes Tank Company, Inc. Customer is responsible for verifying correctness of size, location of fittings, accessories and coatings shown on this drawing. Hughes Tank Company, Inc. shall be responsible only for the items indicated in this fabrication drawing unless otherwise noted.

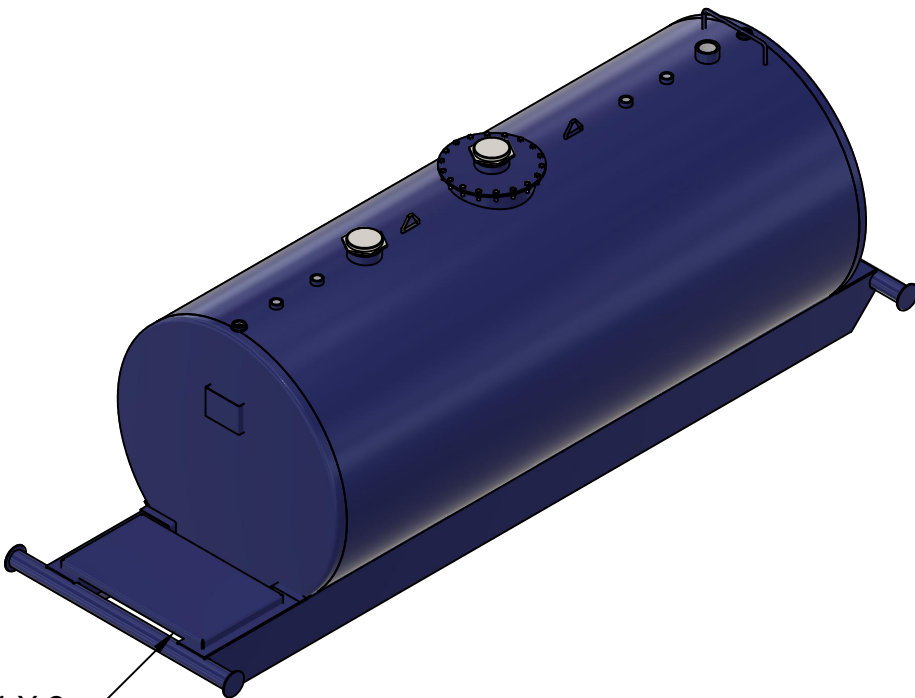
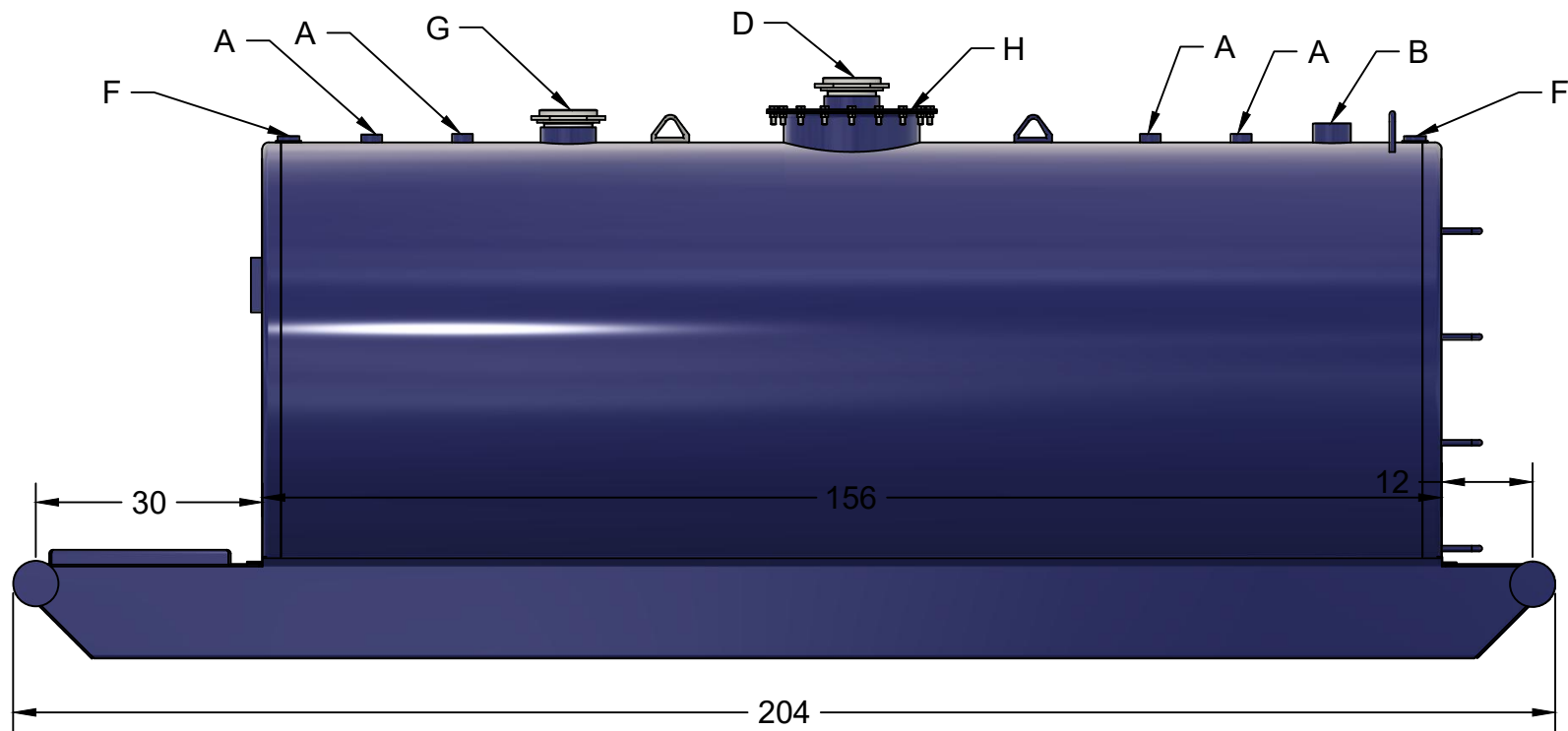

42 X 24 X 2  
PUMP PLATFORM

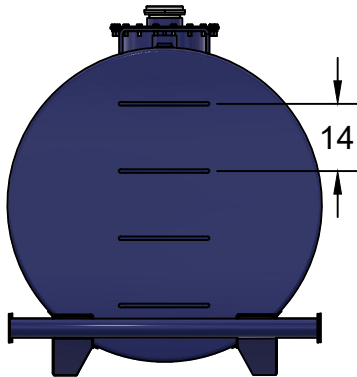
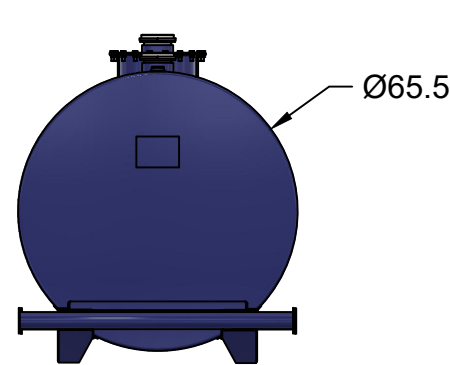

- Inspection: Hughes Tank Company, Inc
  - Material: A36 Mild Carbon Steel
  - Internal: Surface prep - Clean of Debris
  - External: Surface prep - SSPC-SP6 (commercial blast)
  - External: (R. BLUE) Enviroastic 940 LV Polyurthane
- Test: Inner tank: 5PSIG Hydrostatic  
Outer tank: Hydrostatic  
Pressure Test: 3-5 PSI
- Lables: - UL 142
- This drawing may contain **CONFIDENTIAL** information and is intended **ONLY** for the use of the specific individual to which it is addressed.

CUSTOMER APROVAL  SIGNATURE: _____  DATE: _____	A	Coupling	2"	2" threaded fitting	Primary	
	B	Coupling	4"	4" threaded fitting	Primary	
	C	Coupling	6"	6" threaded fitting	Primary	
	D	Emergency Vent	6"	6"emergency vent	Primary	
	E	Lifting Lug	Med.	Medium lifting lug	Secondary	
	F	Interstitial	2"	2" interstitial fitting	Secondary	
	G	Emergency Vent	6"	6"emergency vent	Secondary	
	H	Manhole	18"	18" manhole	Primary	
<u>Note:</u> At no time shall the pressure in the secondary tank exceed the pressure in the primary tank.						
CUSTOMER: <b>REEDER</b>						
PROJECT: <b>2000g. UL 142 DW</b>						
APPROVED Bobby Hughes						
CHECKED Paige Hughes						
DRAWN JD Hughes			WEIGHT		REV	SHEET 1/1



HUGHES TANK COMPANY, INC.

O: (972) - 366 - 8684  
F: (972) - 366 - 3130

2900 N. FM 157  
VENUS, TX 76084

P.O. BOX 570  
VENUS, TX 76084

- DESIGN:** Fabricated per UL 142 specifications double wall construction.
- Air test are no less than 3 PSI and no more than 5 PSI.
  - Primary tank to be tested alone. Secondary tank to be pressure tested with primary tank. This shall be accomplished by bleeding air from the primary tank to the secondary tank.



► **DESIGN** - LED AREA LIGHT WITH PHOTOCCELL has die-cast aluminum housing with excellent heat dissipation and anti-glare PC type III-M lens with even light distribution. With 10kV surge protection, it is designed to operate on 120-277V circuits with a 0-10V dimmable driver. Built-in photocell switches the fixture on at night time. Photocell can be easily deactivated with a simple switch.

► **SURGE PROTECTION** - 10kV protects the fixture from voltage spikes and current surges.

► **3G** - Vibration rated, withstands conditions with repeated vibration, making it conform to standards for roadway.

► **INSTALLATION** - This fixture is Wet Locations rated and can be pole, post, or wall mounted using the slip fitter bracket, arm bracket, floodlight, full tununion, tenon and wall mounting bracket. It comes with a 4 ft cord. Perfect commercial or industrial solution for roadway lighting, highway lighting, sport lighting, parks, parking lots, backyards, and many other applications.

► **ADVANTAGES** - With calculated lifespan up to 163,000 hours, these fixtures are made to last decades under normal operation! ASD provides a 5-year limited warranty along with UL and DLC Premium certifications to guarantee top quality products and safety!







Catalog number	
Notes	
Type	



Model	Watts	Voltage	Dimmable	Lumens	CCT	Finish	Dimensions (LxWxH)	Cord	Bracket	Pre-installed
LSB5										
ASD-LSB5-150050BR	150W	120-277 V	0-10 V	22,398 lm	5,000 K	Bronze	14-5/16" x 11" x 2-13/16"	3.9 ft	-	Photocell
ASD-LSB5-150050BR-SF	150W	120-277 V	0-10 V	22,398 lm	5,000 K	Bronze	21-5/16" x 11" x 3-1/16"	3.9 ft	Slip fitter	Photocell
ASD-LSB5-150050BR-AMR	150W	120-277 V	0-10 V	22,398 lm	5,000 K	Bronze	22-1/4" x 11" x 6-1/4"	3.9 ft	Arm	Photocell
ASD-LSB5-200050BR	200W	120-277 V	0-10 V	30,071 lm	5,000 K	Bronze	14-5/16" x 11" x 2-13/16"	3.9 ft	-	Photocell
ASD-LSB5-200050BR-SF	200W	120-277 V	0-10 V	30,071 lm	5,000 K	Bronze	21-5/16" x 11" x 3-1/16"	3.9 ft	Slip fitter	Photocell
ASD-LSB5-200050BR-AMR	200W	120-277 V	0-10 V	30,071 lm	5,000 K	Bronze	22-1/4" x 11" x 6-1/4"	3.9 ft	Arm	Photocell
ASD-LSB5-240050BR	240W	120-277 V	0-10 V	35,843 lm	5,000 K	Bronze	18-1/2" x 12-9/16" x 2-13/16"	3.9 ft	-	Photocell
ASD-LSB5-300050BR	300W	120-277 V	0-10 V	44,069 lm	5,000 K	Bronze	18-1/2" x 12-9/16" x 2-13/16"	3.9 ft	-	Photocell
ASD-LSB5-300050BR-SF	300W	120-277 V	0-10 V	44,069 lm	5,000 K	Bronze	25-9/16" x 12-9/16" x 3-1/16"	3.9 ft	Slip fitter	Photocell
ASD-LSB5-300050BR-AMR	300W	120-277 V	0-10 V	44,069 lm	5,000 K	Bronze	26-1/2" x 12-9/16" x 6-1/4"	3.9 ft	Arm	Photocell



PRODUCT SPECIFICATIONS:

Construction & Materials						
Housing	Aluminum					
Lens	PC					
Finish	White, Silver, Bronze, Black					
Weight	ASD-LSB5-150D50BR	7.1 lbs (3.2 kg)	ASD-LSB5-200D50BR	7.1 lbs (3.2 kg)	ASD-LSB5-240D50BR	9.3 lbs (4.2 kg)
	ASD-LSB5-150D50BR-SF	8.6 lbs (3.9 kg)	ASD-LSB5-200D50BR-SF	8.6 lbs (3.9 kg)	ASD-LSB5-300D50BR	10.8 lbs (4.9 kg)
	ASD-LSB5-150D50BR-AMR	9.4 lbs (4.3 kg)	ASD-LSB5-200D50BR-AMR	9.4 lbs (4.3 kg)	ASD-LSB5-300D50BR-SF	10.8 lbs (4.9 kg)
Environmental system						
Work environment	Suitable for Wet Locations, IP66					
Operating temperature	-40°F to 122°F (-40°C to 50°C)					
L-70 Life	R > 54,000 hrs; C > 63,000 hrs					
Optical system						
Color temperature	5,000 K					
CRI	> 70					
Electrical system						
Input voltage	120-277 V		ASD-LSB5-200D50BR		ASD-LSB5-240D50BR	3 A
Max input current	ASD-LSB5-150D50BR		ASD-LSB5-200D50BR-SF		ASD-LSB5-300D50BR	
	ASD-LSB5-150D50BR-SF	2 A	ASD-LSB5-200D50BR-AMR	2.6 A	ASD-LSB5-300D50BR-SF	4 A
	ASD-LSB5-150D50BR-AMR				ASD-LSB5-300D50BR-AMR	
Brush current (Action time)	75 A (0.35 S)					
Off state power	0W		ASD-LSB5-200D50BR		ASD-LSB5-240D50BR	240W
Power consumption	ASD-LSB5-150D50BR		ASD-LSB5-200D50BR-SF	200W	ASD-LSB5-300D50BR	
	ASD-LSB5-150D50BR-SF	150W	ASD-LSB5-200D50BR-AMR		ASD-LSB5-300D50BR-SF	300W
	ASD-LSB5-150D50BR-AMR				ASD-LSB5-300D50BR-AMR	
Power factor	> 0.9					
Output voltage	180-240 V		ASD-LSB5-200D50BR		ASD-LSB5-240D50BR	0.75-1.1 A
Max output current	ASD-LSB5-150D50BR		ASD-LSB5-200D50BR-SF	0.65-0.9 A	ASD-LSB5-300D50BR	
	ASD-LSB5-150D50BR-SF	0.5-0.75 A	ASD-LSB5-200D50BR-AMR		ASD-LSB5-300D50BR-SF	1.1-1.5 A
	ASD-LSB5-150D50BR-AMR				ASD-LSB5-300D50BR-AMR	
Surge protection DM/CM	6 kV / 6 kV					
Effective protected area (EPA) ratings						
Fixture q-by						
	Single	Double 180°	Double 90°	Triple 90°	Triple 120°	Quad 90°
EPA of 150/200W	0.28	0.52	0.52	0.8	0.74	0.8
EPA of 240/300W	0.31	0.61	0.69	0.85	0.83	0.85
Dimming compatible controls						
Brand	Eaton					
Models	SF10P		DF10P			
Regular and voluntary certifications						
5-year limited warranty						
DesignLights Consortium (DLC) listed (Classification: Premium). Main: Outdoor luminaires, General application: High/Very high output (Very high output for models from 240W and higher). Primary use: Outdoor pole/arm-mounted area and roadway luminaires.						
UL certified: E473804						

PACKAGE CONTENTS:

Description		Q-ty
LED Area Light with photocell		1
Box		1



## ACCESSORIES (sold separately):

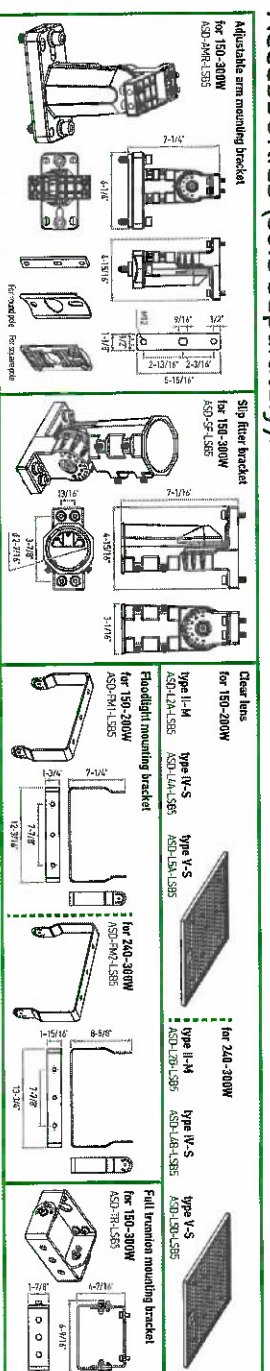

## ACCESSORY COMPATIBILITY LIST:

Accessories	Clear lens for 150-200W ASD-12A-LSBS (type II-M) ASD-16A-LSBS (type IV-S) ASD-15A-LSBS (type V-S)	Clear lens for 240-300W ASD-12B-LSBS (type II-M) ASD-16B-LSBS (type IV-S) ASD-15B-LSBS (type V-S)	Adjustable arm mounting bracket for 150-300W ASD-AMR-LSBS	Slip filter bracket for 150-300W ASD-SF-LSBS	Floodlight mounting bracket for 150-200W ASD-FM-LSBS	Floodlight mounting bracket for 240-300W ASD-FM2-LSBS	Full trunnion mounting bracket for 150-300W ASD-TR-LSBS
ASD-LSBS-150050BR-SF	•						•
ASD-LSBS-150050BR-AMR							
ASD-LSBS-200050BR	•		•				•
ASD-LSBS-200050BR-SF				•			
ASD-LSBS-200050BR-AMR	•						
ASD-LSBS-240050BR		•					•
ASD-LSBS-300050BR			•				
ASD-LSBS-300050BR-SF				•		•	
ASD-LSBS-300050BR-AMR							

## INSTALLATION GUIDE

### IMPORTANT SAFETY INFORMATION:

- ▶ Please read all the instructions below before installation.
- ▶ Make sure that the supply voltage corresponds to the rated product voltage.
- ▶ The product must be installed by a qualified electrician in accordance with the National Electrical Code and corresponding local codes.
- ▶ If the product is damaged, do not use it.

### ⚠ WARNING

**RISK OF PERSONAL INJURY – READ and follow all WARNINGS and installation instructions.** Keep or give to the owner for future reference.  
**Risk of cuts:** Wear gloves to prevent cuts or abrasions when removing from carton, handling, installing and maintaining this product.  
**Risk of electric shock:** This product must be installed in accordance with the applicable installation code by a person familiar with the construction and operation of the product and the hazards involved.  
**Risk of fire:** Minimum 1/4" F supply conductors. Consult a qualified electrician to ensure correct branch circuit conductor.  
ASD® assumes no responsibility for claims arising out of improper or careless installation or handling of this product.

## ELECTRICAL SCHEMATIC DIAGRAM:

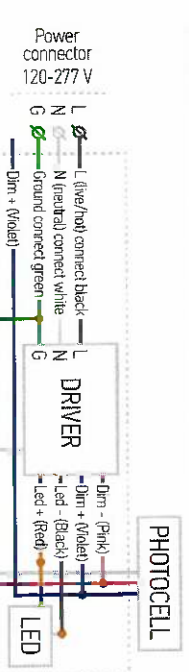

## BUILT-IN PHOTOCELL INFORMATION

Specifications	
Light level to turn ON	≤ 80 lux (≤ 7.4 fc)
Light level to turn OFF	≥ 150 lux (≥ 13.7 fc)
Operating temperature	-40°F to 140°F (-40°C to 60°C)

The fixtures with a built-in photocell automatically turn off during daylight hours.



Integrated photocell switches the fixture on at night time. It can be easily deactivated by putting the cap on.



## ADJUSTABLE ARM MOUNTING BRACKET

**ASD-AMR-LSB5** sold separately:

1. Open up the door on the arm bracket (1 screw). Install the mounting arm onto the pole (2 bolts). Make sure the silicone gaskets form a tight seal. Choose gasket depending on the shape of the pole (round or flat).
2. Thread the cord from the fixture through the bracket into the pole and tighten the two M8 screws on the body of the light. Wire in accordance with wiring schematic.
3. Adjust the fixture angle with the large hex bolt on the side of the bracket if necessary.

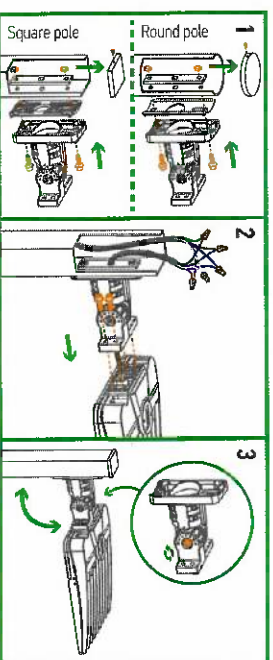

## SLIP FITTER MOUNTING BRACKET

**ASD-SF-LSB5** sold separately:

1. Thread the wire through the slip fitter and secure it to the fixture with four screws.
2. Make AC connections in accordance with wiring diagram.
3. If necessary adjust the fixture angle with the large hex bolt on the side of the slip fitter.

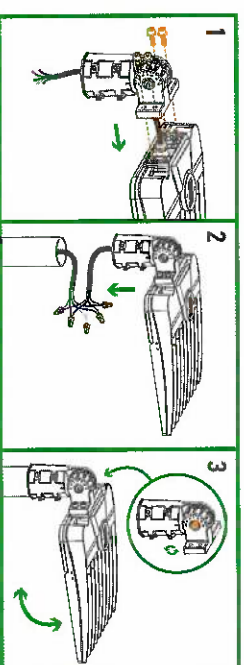

The wiring is inside the pole, the side is sealed with a rubber ring and secured with screws, preventing water from getting inside the fixture.

## FLOODLIGHT MOUNTING BRACKET

**ASD-FM1-LSB5 ASD-FM2-LSB5** sold separately:

1. Drill holes on the mounting surface corresponding to the holes in the arm. Attach fixture to bracket with 2 screws.
2. Align bracket holes with mounting surface holes and secure with 2 screws.
3. Wire in accordance with the wiring schematic. Seal the connections with the back plate of the fixture. Adjust fixture angle as needed.

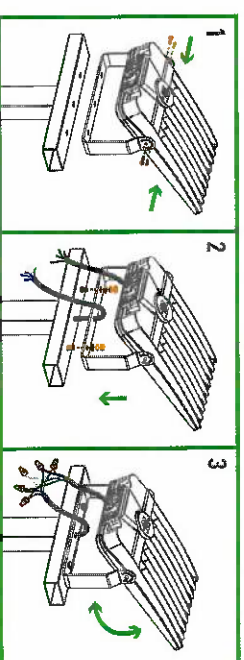

## FULL TRUNNION MOUNTING BRACKET

**ASD-TR-LSB5** sold separately:

1. Drill holes on the mounting surface matching in size to the holes on the arm. Secure the bracket on the wall with screws. Pull wires through mount, secure fixture to the bracket.
2. Wire the AC power into the water tight junction box as shown in the wiring schematic diagram. Adjust the screw position to get desired angle when necessary.

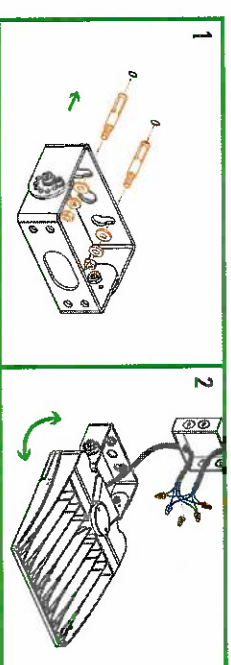

## LENS INSTALLATION

ASD-L2A-LSB5	ASD-L4A-LSB5	ASD-L5A-LSB5
ASD-L2B-LSB5	ASD-L4B-LSB5	ASD-L5B-LSB5

**sold separately:**

1. Unscrew all screws from the original lens (1-3-M) on the housing.
2. Install the rubber ring on new lens (1/4-TS-M, sold separately).
3. Place the lens on the housing and make sure it fits the LEDs correctly.
4. Tighten all the screws back.

Lens	
150W, 200W	1 lens (L2A, L4A, L5A)
240W, 300W	1 lens (L2B, L4B, L5B)

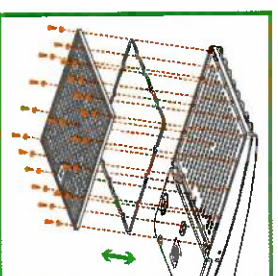

Model	Blue rating
ASD-LSB5-150050BR	
ASD-LSB5-150050BR-SF	B4-U3-G3
ASD-LSB5-150050BR-AMR	
ASD-LSB5-200050BR	
ASD-LSB5-200050BR-SF	B4-U3-G4
ASD-LSB5-200050BR-AMR	
ASD-LSB5-240050BR	
ASD-LSB5-300050BR	
ASD-LSB5-300050BR-SF	B5-U3-G5
ASD-LSB5-300050BR-AMR	

ORDERING INFORMATION

Model	UPC	Pcs. per carton	Carton size	Carton weight
ASD-L-SB5-150D50BR	810128110945	1	16.9" x 11.8" x 4.3"	8.6 lbs
ASD-L-SB5-150D50BR-SF	810128113175	1	16.9" x 11.9" x 6.1"	10.4 lbs
ASD-L-SB5-150D50BR-AMR	810128113267	1	16.9" x 11.9" x 8.1"	11.9 lbs
ASD-L-SB5-200D50BR	810128110952	1	16.9" x 11.8" x 4.3"	8.6 lbs
ASD-L-SB5-200D50BR-SF	810128113182	1	16.9" x 11.9" x 6.1"	10.4 lbs
ASD-L-SB5-200D50BR-AMR	810128113274	1	16.9" x 11.9" x 8.1"	11.9 lbs
ASD-L-SB5-240D50BR	810128112444	1	20.9" x 13.4" x 4.3"	11 lbs
ASD-L-SB5-300D50BR	810128110976	1	20.9" x 13.4" x 4.3"	11 lbs
ASD-L-SB5-300D50BR-SF	810128113199	1	20.9" x 13.5" x 5.7"	12.1 lbs
ASD-L-SB5-300D50BR-AMR	810128113281	1	20.9" x 13.5" x 7.7"	12.8 lbs

ACCESSORIES:

Model	Description	UPC	Pcs. per carton	Carton size	Carton weight	ETIM 14
ASD-L-2A-L-SB5	Clear lens type II-M for 150-200W	810128114103	30	18.5" x 11" x 9.1"	25.4 lbs	10810128114100
ASD-L-4A-L-SB5	Clear lens type IV-S for 150-200W	810128114127	50	18.5" x 11" x 9.1"	25.4 lbs	10810128114124
ASD-L-5A-L-SB5	Clear lens type V-S for 150-200W	810128114141	50	18.5" x 11" x 9.1"	25.4 lbs	10810128114148
ASD-L-2B-L-SB5	Clear lens type II-M for 240-300W	810128114110	25	12.6" x 12.6" x 2.8"	19.1 lbs	10810128114117
ASD-L-4B-L-SB5	Clear lens type IV-S for 240-300W	810128114134	25	12.6" x 12.6" x 2.8"	19.1 lbs	10810128114131
ASD-L-5B-L-SB5	Clear lens type V-S for 240-300W	810128114158	25	12.6" x 12.6" x 2.8"	19.1 lbs	10810128114155
ASD-AMR-L-SB5-WH	Adjustable arm mounting bracket white for 150-300W	810128113298	20	27.4" x 16.5" x 14"	52.9 lbs	10810128113295
ASD-AMR-L-SB5-SL	Adjustable arm mounting bracket silver for 150-300W	810128112253	20	27.4" x 16.5" x 14"	52.9 lbs	10810128112257
ASD-AMR-L-SB5-BR	Adjustable arm mounting bracket bronze for 150-300W	810128112246	20	27.4" x 16.5" x 14"	52.9 lbs	10810128112240
ASD-AMR-L-SB5-BK	Adjustable arm mounting bracket black for 150-300W	810128112239	20	27.4" x 16.5" x 14"	52.9 lbs	10810128112233
ASD-SF-L-SB5-WH	Slip filter mounting bracket white for 150-300W	810128113304	20	15.5" x 17.7" x 11.1"	35.3 lbs	10810128113301
ASD-SF-L-SB5-SL	Slip filter mounting bracket silver for 150-300W	810128111973	20	15.5" x 17.7" x 11.1"	35.3 lbs	10810128111970
ASD-SF-L-SB5-BR	Slip filter mounting bracket bronze for 150-300W	810128111941	20	15.5" x 17.7" x 11.1"	35.3 lbs	10810128111945
ASD-SF-L-SB5-BK	Slip filter mounting bracket black for 150-300W	810128111966	20	15.5" x 17.7" x 11.1"	35.3 lbs	10810128111963
ASD-FM1-L-SB5-WH	Floodlight mounting bracket white for 150-200W	810128114073	10	13.2" x 15.9" x 12.8"	19.8 lbs	10810128114070
ASD-FM1-L-SB5-SL	Floodlight mounting bracket silver for 150-200W	810128112024	10	13.2" x 15.9" x 12.8"	19.8 lbs	10810128112021
ASD-FM1-L-SB5-BR	Floodlight mounting bracket bronze for 150-200W	810128112017	10	13.2" x 15.9" x 12.8"	19.8 lbs	10810128112014
ASD-FM1-L-SB5-BK	Floodlight mounting bracket black for 150-200W	810128112000	10	13.2" x 15.9" x 12.8"	19.8 lbs	10810128112007
ASD-FM2-L-SB5-WH	Floodlight mounting bracket white for 240-300W	810128114080	10	14.8" x 13.8" x 18.9"	26.5 lbs	10810128114087
ASD-FM2-L-SB5-SL	Floodlight mounting bracket silver for 240-300W	810128113144	10	14.8" x 13.8" x 18.9"	26.5 lbs	10810128113141
ASD-FM2-L-SB5-BR	Floodlight mounting bracket bronze for 240-300W	810128113137	10	14.8" x 13.8" x 18.9"	26.5 lbs	10810128113134
ASD-FM2-L-SB5-BK	Floodlight mounting bracket black for 240-300W	810128113120	10	14.8" x 13.8" x 18.9"	26.5 lbs	10810128113127
ASD-TR-L-SB5-WH	Full trunion mounting bracket white for 150-300W	810128113474	20	14.8" x 10.3" x 12.4"	44.1 lbs	10810128113431
ASD-TR-L-SB5-SL	Full trunion mounting bracket silver for 150-300W	810128111997	20	14.8" x 10.3" x 12.4"	44.1 lbs	10810128111994
ASD-TR-L-SB5-BR	Full trunion mounting bracket bronze for 150-300W	810128111058	20	14.8" x 10.3" x 12.4"	44.1 lbs	10810128111055
ASD-TR-L-SB5-BK	Full trunion mounting bracket black for 150-300W	810128111980	20	14.8" x 10.3" x 12.4"	44.1 lbs	10810128111987



POST TOP BULLHORN BRACKET		EPA (SQ. FT.)
CATALOG #	DESCRIPTION	
PTB-2	2 IN LINE FLOOD MOUNT	1.0

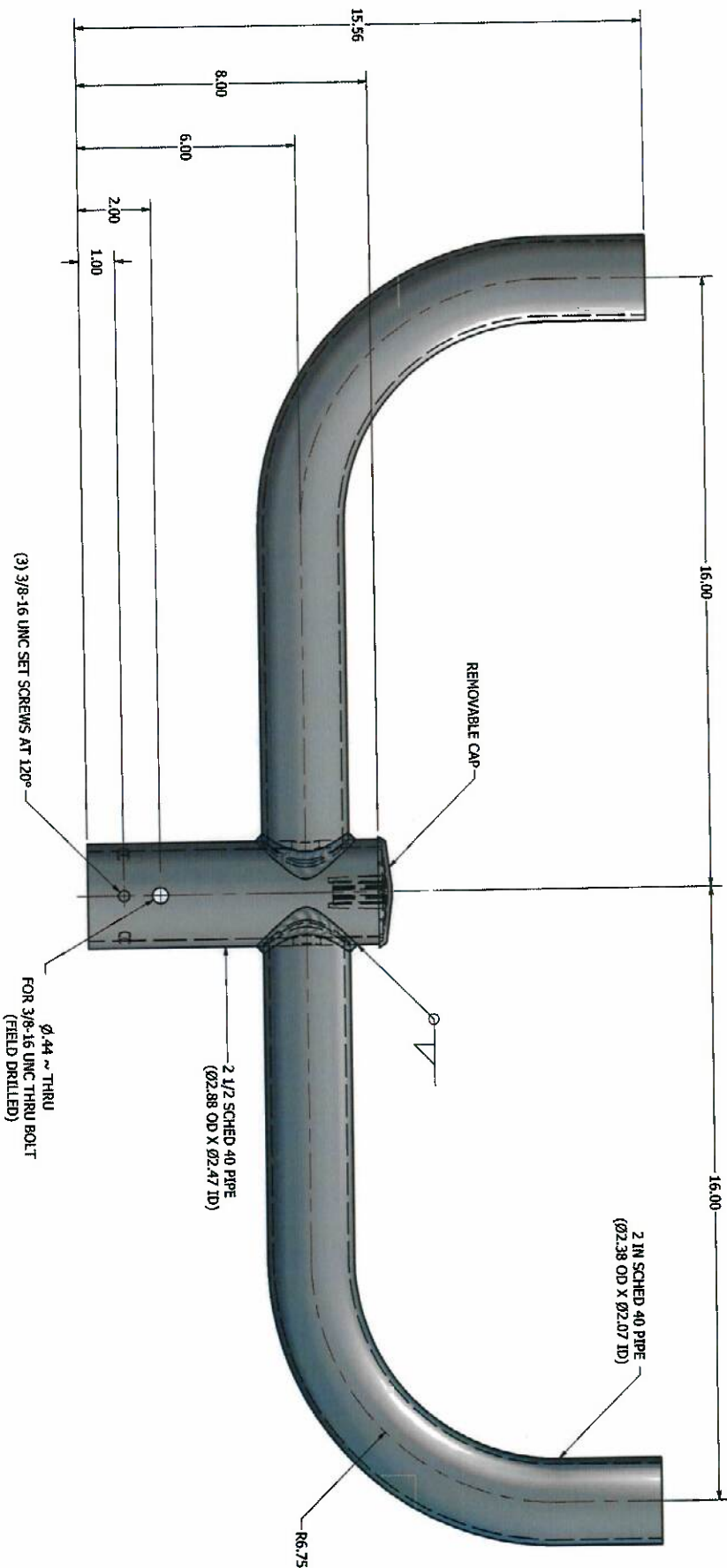

NOTE: SERIES PTB POLE TOP FLOODLIGHT MOUNTING BRACKETS SLIP FIT Ø2.38 O.D. PIPE SIZE. BRACKET TENONS ARE Ø2.38 O.D. PIPE SIZE. EACH BRACKET HAS A MAXIMUM CAPACITY OF TWO, THREE, OR FOUR 1000 WATT FLOODLIGHTS, DEPENDING ON MOUNTING CONFIGURATION. SLIP FITTERS FOR Ø3.00 IN & Ø4.00 IN TENONS ARE AVAILABLE UPON REQUEST. BRACKETS ARE FINISHED TO MATCH POLE REQUIREMENTS.

BRACKETS CATALOGED ARE CONSTRUCTED OF STEEL AND ARE FOR USE ON STEEL AND ALUMINUM POLES. IF ALUMINUM BRACKETS ARE REQUIRED FOR ALUMINUM POLES, PLEASE CONTACT YOUR REPRESENTATIVE.

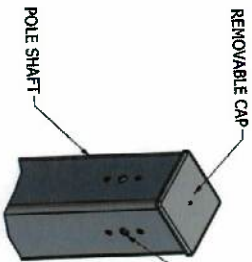

REMOVABLE CAP

DRILL PER FIXTURE REQUIREMENTS:  
D1 - DRILLED FOR 1 FIXTURE  
D2 - DRILLED FOR 2 FIXTURES AT 90° OR 180°  
D3 - DRILLED FOR 3 FIXTURES  
D4 - DRILLED FOR 4 FIXTURES

## DRILL MOUNT OPTIONS

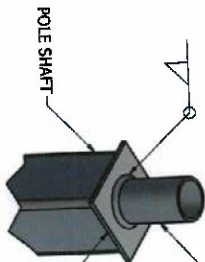

TENON MOUNT OPTIONS:  
T2 - Ø2.38 OD X 4.00 LG  
T2.5 - Ø2.88 OD X 4.00 LG  
T3 - Ø3.00 OD X 5.00 LG  
T4 - Ø4.00 OD X 6.00 LG

## TENON MOUNT OPTIONS

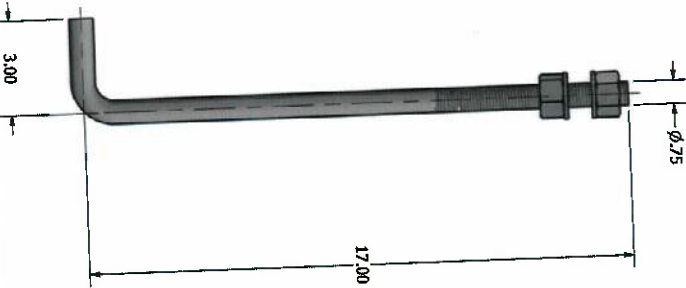

Ø.75 X 20.00 ANCHOR BOLT

POLE  
HEIGHT

3.00 X 5.00  
HAND HOLE  
W/ COVER

14.00

## POLE DETAIL

NO.		POLE SPECIFICATIONS		MIN. YIELD (P.S.I.)	
COMPONENT		ASTM DESIGNATION		46,000	
1.	POLE SHAFT	A-500 GR. B	A36	36,000	
2.	BASE PLATE	F1554 GR. 55	A153	55,000	
3.	ANCHOR BOLTS				
4.	GALVANIZED HARDWARE				
POLES SHALL HAVE A POLYESTER POWDER COAT FINISH IN A STANDARD COLOR.					
POLE DIMENSIONS					
POLE HGT (FT.)	TOP SQ. SIZE (IN.)	BOLT SQ. SIZE (IN.)	GAGE	MTG. HGT. (FT.)	
20'	4.00	4.00	11 GAGE	20'	
BASE PLATE DIMENSIONS					
BOLT CIRCLE (IN.)	BASE PLATE DIM. (IN.)	BOLT HOLE (IN.)	PLATE THK. (IN.)		
8.00/9.00	8.00 SQ	1.00	.75		
ANCHOR BOLT DIM. (IN.)					
.75	ANCHOR BOLT LENGTH (IN.)	20.00			
ALLOWABLE WIND LOADING (SQ. FT.)					
WIND*	INDICATED EPA	80 MPH	90 MPH	100 MPH	120 MPH
EPA		9.0	7.3	5.9	4.2

\*WITH 1.3 GUST FACTOR

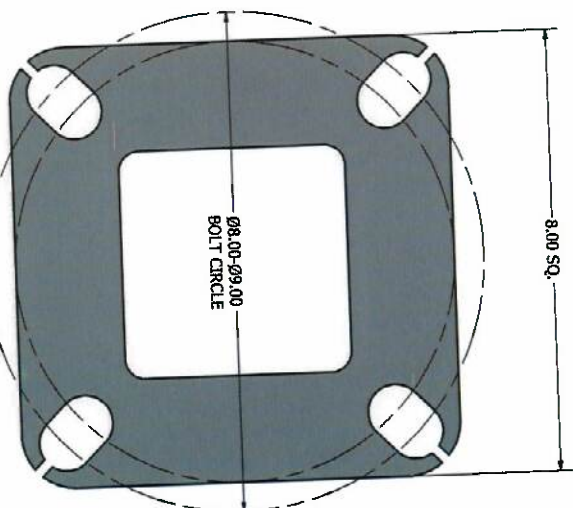

8.00 X 8.00 X .75 THK. BASE PLATE

SOME GEOGRAPHICAL AREAS HAVE SPECIAL WIND CONDITIONS THAT CAN CREATE WIND INDUCED VIBRATIONS CAUSING A FATIGUE PROBLEM. NO METHOD HAS YET BEEN FOUND FOR PREDICTING DESTRUCTIVE LIGHTNING POLE VIBRATION. THESE CONDITIONS ARE UNIQUE AND CANNOT BE GUARANTEED. ENGINEER AND ARE THE RESPONSIBILITY OF A LOCAL SITE ENGINEER.



# UNITED LIGHTING STANDARDS

A DWM COMPANY

www.unitedlightingstandards.com

## POLE ORDERING GUIDE

### ORDER NUMBER TEMPLATE

#### Example Order Number

Fixture			Mounting Type			Finish			Options			Accessories		
Brand	Product	Number	Design	Mounting Height	Shaft Size	Wall Thickness	Design	Orientation	Height From Base	Design	Orientation	Height From Base		
RPSQ	20	4	11	AB	T2	DB	WB-15	@90	10'	FH	@180	9'		

#### Build Your Order Number

Fixture			Mounting Type			Finish			Options			Accessories		
Brand	Product	Number	Design	Mounting Height	Shaft Size	Wall Thickness	Design	Orientation	Height From Base	Design	Orientation	Height From Base		
RPSQ	20	4	11	AB	T2	DB								

#### Mounting Type

AB = Anchor Base  
EMB = Embedded (Direct Burial)

#### Finish

WH = White  
TWH = Textured White  
DB = Dark Bronze  
TMB = Textured Medium Bronze  
HB = Harvest Bronze  
NB = New Bronze  
SL = Silver  
MGY = Medium Gray  
GR = Gray  
TGR = Textured Gray  
GM = Graphite Metallic  
DP = Dark Platinum  
MA = Matte Aluminum  
PSP = Platinum Silver  
BK = Black

#### Fixture Mounting Arrangement

D1 D4  
D2@90 T2  
D2@180 T2.5  
D3@90 T3  
D3@120\* T4

#### Options

CMB = Camera Mounting Bracket  
CMP = Camera Mounting Plate  
WB-15 = Welded Bracket  
WC = Welded Coupling (denote size)  
WN = Welded Nipple (denote size)  
Festoon = Festoon Provision  
CSBC = Custom Steel Base Cover  
VD = Vibration Damper  
GFCI/UC = Ground Fault Circuit Interrupter with In-Use Cover  
UL = UL Listed\*\*

#### Accessories

TB = Transformer Base\*  
ABS-BC = ABS Base Cover\*  
LW = Lowering Winch  
LW-ELECTRIC = Electric Lowering Winch  
BA = Banner Arm  
FH = Flag Holder  
PTTA = Pole Top Tension Adapter\*

Note: N/A = Not Applicable