

Revision Schedule		
Rev. #	Revision Description	Revision Date

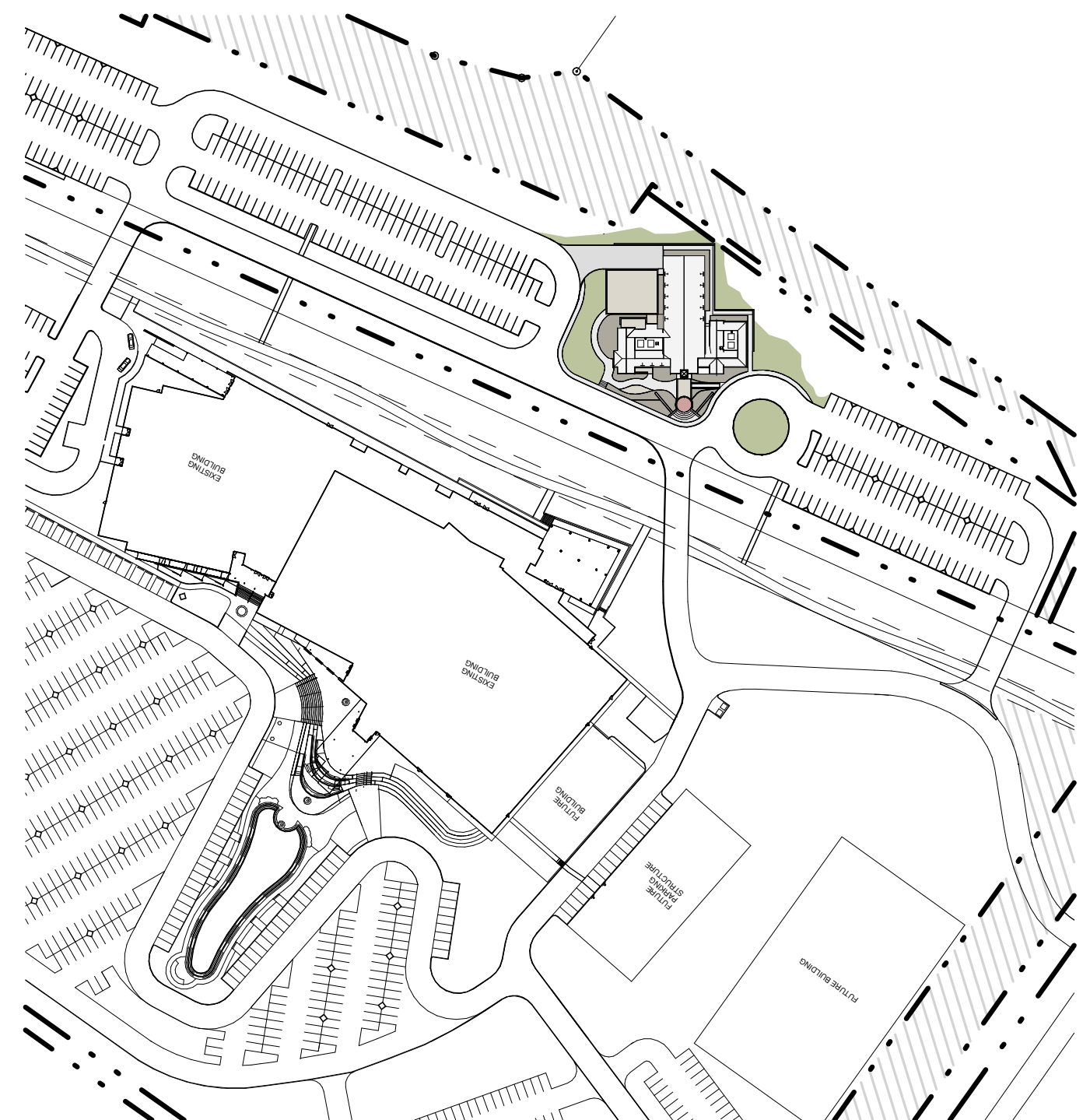

**2** OVERALL SITE  
**A110** 1" = 160'-0"

**1** ARCHITECTURAL SITE PLAN  
**A110** 1" = 20'-0"

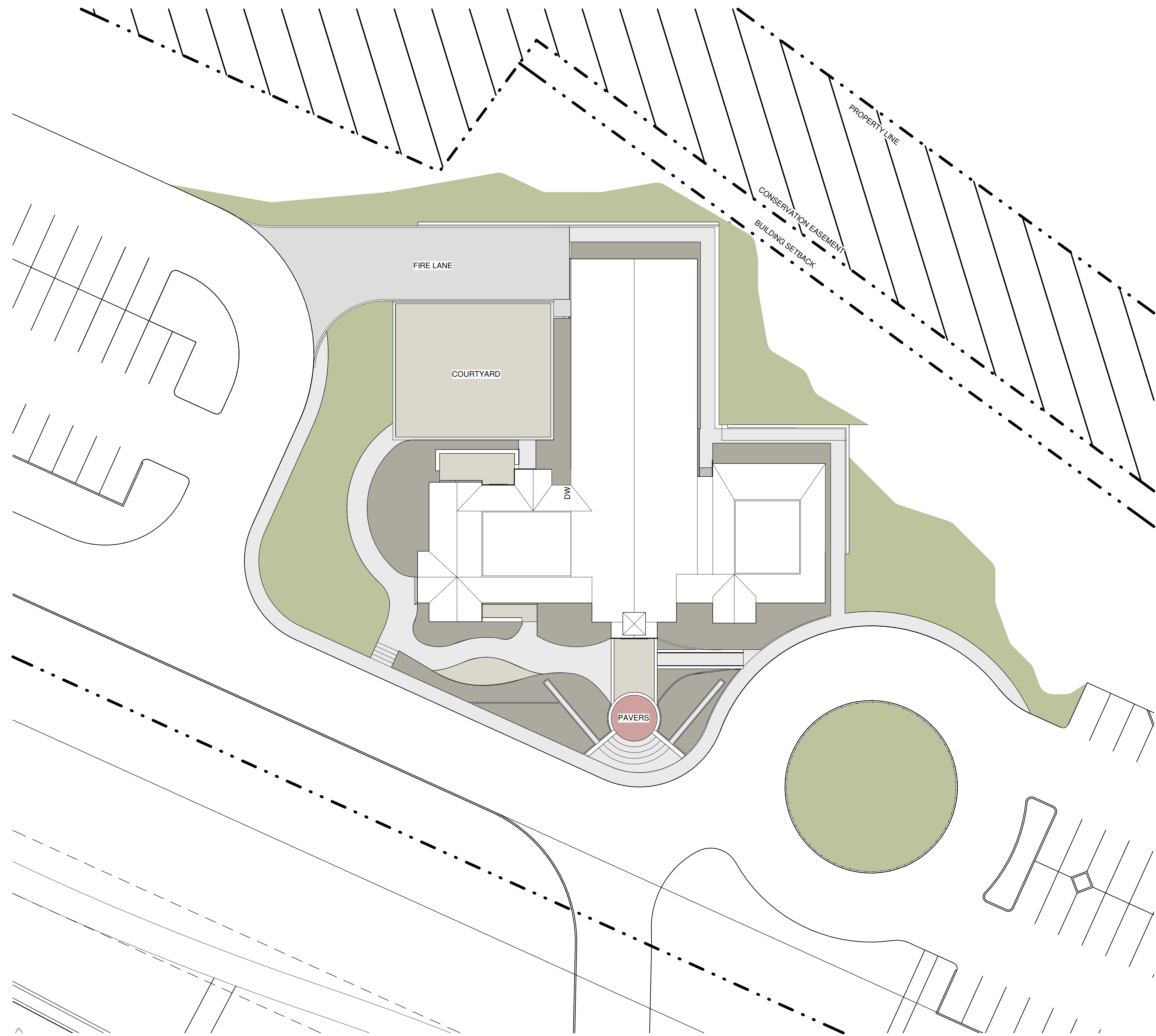
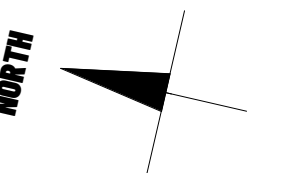

NOT TO BE USED FOR PERMITTING  
OR CONSTRUCTION

ANDREW OXLEY

THE ARCHITECT AND THE ARCHITECT'S CONSULTANTS SHALL BE SEEN AS THE AUTHOR AND OWNER OF THEIR RESPECTIVE INSTRUMENTS OF SERVICE, INCLUDING THE DRAWINGS AND SPECIFICATIONS, AND SHALL RETAIN ALL COMMON LAW, STATUTORY AND OTHER RESERVED RIGHTS, INCLUDING COPYRIGHT. PERMISSION OR DISTRIBUTION OF INSTRUMENTS OF SERVICE TO ANY OTHER REGULAR OR IRREGULAR REQUIREMENTS OR FOR SIMILAR PURPOSES IN CONNECTION WITH THE PROJECT IS NOT TO BE CONSIDERED AS CONSTRUCTION OR PERMITTING OF THE RESERVES RIGHTS OF THE ARCHITECT AND THE ARCHITECT'S CONSULTANTS. INSTRUMENTS OF SERVICE, INCLUDING DRAWINGS, SPECIFICATIONS AND DOCUMENTS IN ELECTRONIC FORM PREPARED BY OXLEY ARCHITECTS, PLLC ARE FOR USE SOLELY WITH RESPECT TO THIS PROJECT. THE INSTRUMENTS OF SERVICE SHALL NOT BE USED BY THE OWNER WITHOUT THE PRIOR WRITTEN APPROVAL OF OXLEY ARCHITECTS, PLLC. USE OF THE INSTRUMENTS OF SERVICE WITHOUT WRITTEN PERMISSION SHALL BE WITHOUT LIABILITY TO OXLEY ARCHITECTS, PLLC AND ITS CONSULTANTS.

**MILESTONE CHAPEL**

201 MOUNT GILEAD ROAD  
KELLER, TEXAS 76248

2023.008  
OCTOBER 30, 2023

ARCHITECTURAL SITE PLAN