

EXHIBIT B



NOTE:
ALL FUTURE PHASE UTILITY
LOCATIONS SHOWN ARE GRAPHICAL
ONLY AND ARE SUBJECT TO CHANGE
DURING ENGINEERING DESIGN AND
UPON APPROVAL BY THE CITY.

SITE SUMMARY:

- ① Phase 1 Club House 2,288sf
 - a. Future expansion to 2 story 12,000sf
 - b. Outdoor patio and amenities including pool, seating, deck, fire pit & service
 - c. Uses: Gym, Locker Rooms, Physical Therapy, Bar Lounge, Restaurant, Spa Room, Daycare, Reception & Pro-Shop
- ② Tennis Courts (35)
- ③ Family Lodging – 4 @ 1500sf
- ④ Dormitories – Boys and Girls separate buildings/ 2 story with 2800sf first floor to total 5600sf
- ⑤ Existing Building – Renovated to be used as Junior Clubhouse, Training and Office. Will also include Dining Hall, Small Kitchen, Pro-shop, Vending, Locker Room and Fitness Center.
- ⑥ Golf Short Course
- ⑦ Future residence for owners

LEGEND

- W — Proposed Water
- S — Proposed Sanitary Sewer

GRAPHIC SCALE

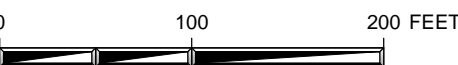

1"=100'-0"

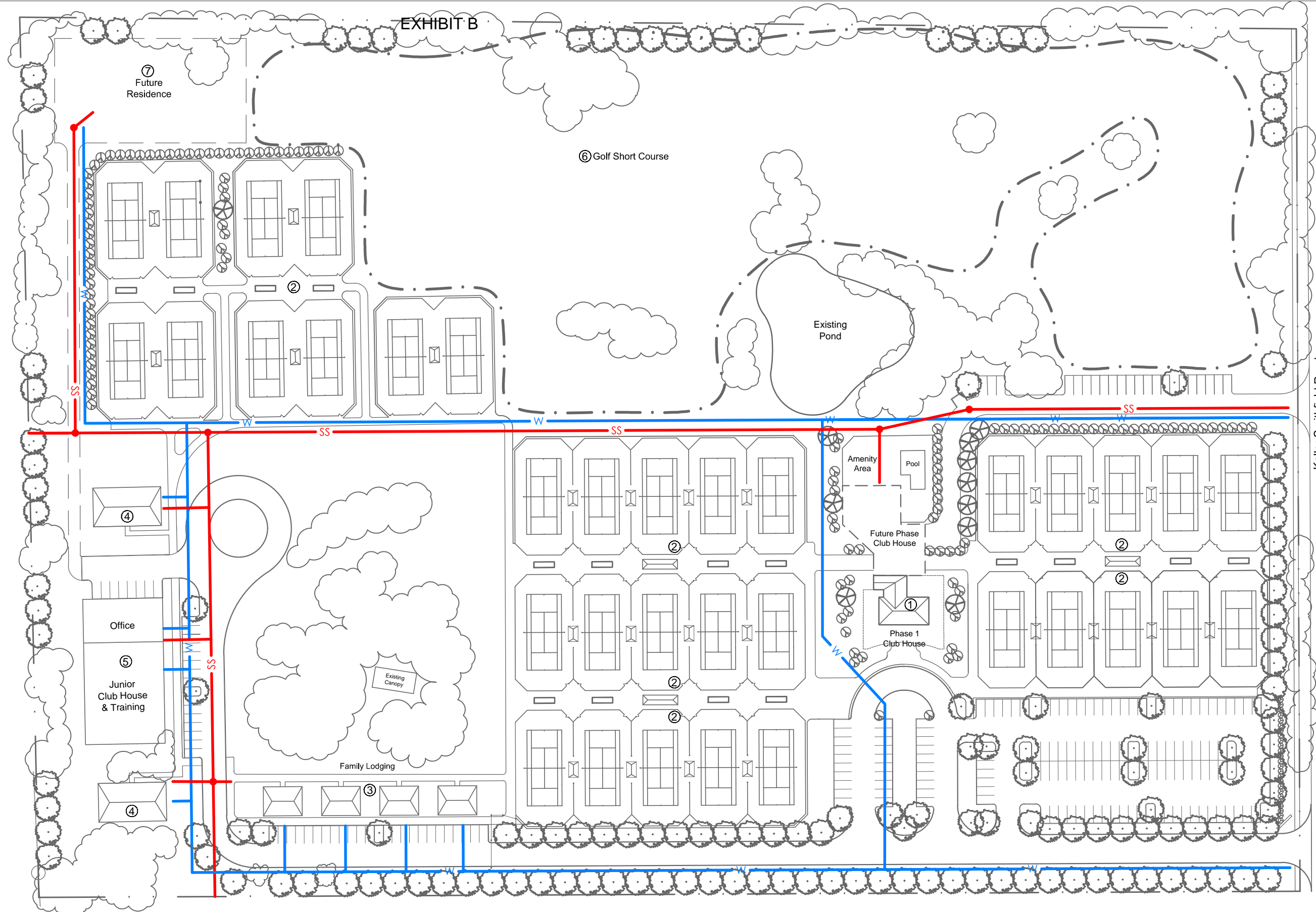

Prepared By:



8951 Cypress Waters Blvd., Ste 150 ■ Dallas, Texas 75019 ■ (817) 328-3200

THE BIRCH
OVERALL UTILITY CONCEPT PLAN
Keller, TX

DECEMBER 12, 2016