

PLANT SCHEDULE

TREES	QTY	BOTANICAL NAME	COMMON NAME	CONT	CAL	SIZE
DECIDUOUS TREES	QTY	BOTANICAL NAME	COMMON NAME	CONT	CAL	SIZE
FRA TE2	5	FRAXINUS TEXENSIS	TEXAS ASH	B & B	4" CAL	
GLE IN6	1	GLEDITSIA TRIACANTHOS INERMIS 'TRUESHADE'	THORNLESS HONEY LOCUST	B & B	3" CAL	
PIS CHI	3	PISTACIA CHINENSIS	CHINESE PISTACHE	B & B	3" CAL	
QUE TEX	5	QUERCUS TEXANA	TEXAS RED OAK	B & B	4" CAL	
ULM ALL	5	ULMUS PARVIFOLIA 'ALLEE'	ALLEE LACEBARK ELM	B & B	3" CAL	
EVERGREEN TREES	QTY	BOTANICAL NAME	COMMON NAME	CONT	CAL	SIZE
CUP ARI	3	CUPRESSUS ARIZONICA	ARIZONA CYPRESS	B & B	7 GAL	11'-12'
ILE VOM	5	ILEX VOMITORIA	YAUPON HOLLY	B & B	7 GAL	
PIN ELD	4	PINUS ELADICA	AFGHAN PINE	B & B	8'-10' H	
SHRUBS	QTY	BOTANICAL NAME	COMMON NAME	CONT	POINT	
CHA TEX	16	CHAENOMELES JAPONICA 'TEXAS SCARLET'	JAPANESE FLOWERING QUINCE	5 GAL		
HES PAR	8	HESPERALOE PARVIFLORA	RED YUCCA	5 GAL		
ILE ROT	14	ILEX CORNUITA 'ROTUNDA'	DWARF CHINESE HOLLY	5 GAL		
ILE NAN	60	ILEX VOMITORIA 'NANA'	DWARF YAUPON	5 GAL		
LAG SPI	2	LAGERSTROEMIA INDICA 'CENTENNIAL SPIRIT'	CRAPE MYRTLE	5 GAL		
MAH BEA	3	MAHONIA BEALEI	LEATHERLEAF MAHONIA	5 GAL		
PIT W14	5	PITOSPORUM TOBIRA 'WHEELER'S DWARF'	DWARF PITOSPORUM	5 GAL		
ANNUALS/PERENNIALS	QTY	BOTANICAL NAME	COMMON NAME	CONT	POINT	
AST OB2	4	ASTER OBLONGIFOLIUS	FALL ASTER	1 GAL		
COR TIC	2	COREOPSIS GRANDIFLORA 'SUNRAY'	SUNRAY TICKSEED	1 GAL		
SAL GRE	8	SALVIA GREGGII	AUTUMN SAGE	5 GAL		
GRASSES	QTY	BOTANICAL NAME	COMMON NAME	CONT	POINT	
MIS GRA	15	MISCANTHUS SINENSIS 'GRACILLIMUS'	MIDLAND GRASS	5 GAL		
PEN HAM	61	PENNETSETUM ALOPECUROIDES 'HAMELIN'	HAMELIN DWARF FOUNTAIN GRASS	1 GAL		
GROUND COVERS	QTY	BOTANICAL NAME	COMMON NAME	CONT	PNT	
	359	AJUGA REPTANS 'ATROPURPUREA'	BRONZE AJUGA	4" POT		
	1,498	PHYLLOPODIFLORA	LIPPIA	FLAT		
SOD/SEED	QTY	BOTANICAL NAME	COMMON NAME	CONT	PNT	
	18,548 SF	CYNODON DACTYLON 'PATRIOT'	PATRIOT BERMUDA GRASS	SOD	3	

REFERENCE NOTES SCHEDULE

SYMBOL	UNIT PAVING DESCRIPTION	QTY
32-14-01	INSTALL FLAGSTONE ON FIRMED SOIL. FILL SPACES BETWEEN FLAGSTONE WITH DECOMPOSED GRANITEL.	124 SF
SYMBOL	FENCES AND GATES DESCRIPTION	QTY
32-31-01	ORNAMENTAL BRICK COLUMN (2'-8" X 2'-8")	4
32-31-02	ORNAMENTAL BRICK COLUMN (5'-4" X 2'-8")	1
SYMBOL	PLANTING ACCESSORIES DESCRIPTION	QTY
32-94-02	MEDIUM BOULDER (2'-3.5' WIDE) TO BE PLACED SO THAT IT DOES NOT OBSTRUCT VIEW OF MENUE BOARDS.	4
32-94-03	INSTALL BED EDGING PER INDUSTRY STANDARDS	369 LF
32-94-04	INSTALL ROOT BARRIER. CP4824 (48"X24") FROM CENTURY ROOT BARRIER.	359 LF

LANDSCAPE CALCULATIONS	
Site Information:	
Special Zoning District	TC = Town Center District
Parking Provided	51 Stalls
Rear Adjacent to Residential	±164 LF
Street Frontage	±164 LF
East Side Buffer	±383 LF
West Side Buffer	±389 LF
Required: Parking Landscape Requirement	1,275 SF (25 SF/ Stall)
	5 Canopy Trees (1 Tree/12 Stalls)
Rear Buffer	30' Buffer
	Large Canopy Trees (mature spacing)
	5 Gal. Dwarf Yaupon Holly (5' O.C.)
Keller Parkway Buffer	30' Buffer
	Row of 4" Cal. Red Oaks (30' O.C.)
	Row of 5 Gal. Dwarf Yaupon Holly (5' O.C.)
	Special Ornamental Columns (30' O.C.)
East Side Buffer	10' Buffer
	Large Canopy Trees (mature Spacing)
West Side Buffer	10' Buffer
	Large Canopy Trees (mature Spacing)
Provided:	
Parking Landscape Requirement	4,348 SF
	9 Canopy Trees
Rear Buffer	30' Buffer
	5 Large Canopy Trees
	33 Dwarf Yaupon Holly (5' O.C.)
Keller Parkway Buffer	30' Buffer
	5 Red Oaks (30' O.C.)
	5 Yaupon Holly (Tree Form 30' O.C.)
	26 Dwarf Yaupon Holly (5' O.C.)
	4 Special Ornamental Columns (30' O.C.)
East Side Buffer	10' Buffer
	12 Large Canopy Trees (mature Spacing)
West Side Buffer	10' Buffer
	12 Large Canopy Trees (mature Spacing)
Site Totals	38 Trees (24 Deciduous/14 Evergreen)
	107 Shrubs
	73 Ornamental Grasses
	14 Perennials
	1,633 SF Ground Cover
	17,007 SF Surf (Including RoW)

- MAINTENANCE:
- Landscape contractor to maintain the site landscape until final approval from the owner. Once landscape has been approved and accepted by the owner, the owner will take responsibility of routine maintenance.
 - Landscape to be maintained on a regular schedule
 - Maintenance to include (but not limited to) mowing, fertilization, weed removal, pruning, etc.
 - All landscape maintenance to be done in accordance with City of Keller Codes and Ordinances.

IRRIGATION:

All landscaped and turf areas to be irrigated. An detailed irrigation plan will be provided for construction plan review.

LANDSCAPE NOTES

- General Notes
- Contractor shall be responsible for any damage caused to the utilities (both overhead and buried) which may occur due to his action or lack of action on the project site during landscape or irrigation installation. Contractor shall seek the assistance of local utilities and the owner in locating the utilities prior to performing trenching operations in any area.
 - Plant trees three (3) inches above finished grade. Cut and remove twine from around the trunk and ball. Cut and remove burlap from the top 1/2 to 2/3 of the root ball. Plant shrubs two (2) inches above finished grade. Crown Islands 8" above top of curb or as directed on drawing. All planting beds shall have positive drainage out of the bed and away from building.
 - All landscape work to be done in accordance to industry standards.
 - Landscape contractor shall locate all utilities prior to starting work. Landscape contractor will be responsible for the repair of any damage caused to utilities.
- Soil Preparation
- All shrub, groundcover, and seasonal plantings shall receive soil preparation/amendments per specification 02950.
 - Mix 17-6-12 fertilizer into the top two (2) inches of soil in the planting beds at a rate of five (5) pounds per 100 square feet.
 - Each tree shall backfilled with amended native soil (2/3 cotton bur mulch soil conditioner and 1/3 excavated soil from tree pit. For trees smaller than two (2) inch caliper, apply four (4) slow release fertilizer tablets (20-10-5, 21 gram tablets). For trees larger than two (2) inch caliper, apply six (6) slow release fertilizer tablets (20-10-5, 21 gram tablets).
 - All areas of the site (and adjacent street Rights-of-Way that are disturbed by construction shall be sodded with Patriot Bermuda. Sod shall only be installed from April 15 - September 15.
 - May 1 - August 31 - Apply a 16-8-8 fertilizer at a rate of six (6) pounds per 1,000 square feet to all lawn areas.
 - September 1 - April 30 - Apply 6-2-0 fertilizer at a rate of ten (10) pounds per 1,000 square feet of lawn area. This fertilizer shall be applied prior to sodding.
- Planting Notes
- Quantities of materials shown in plant material list is for contractor's convenience and information only. Contractor to verify quantities and provide all plants as specified on landscape plan to provide a complete project.
 - Prior to beginning any work on the site, the landscape contractor shall contact the general contractor/project manager for specific instructions relevant to the sequencing of work.
 - Landscape Architect and/or owner representative reserves the right to revise proposed plant list and/or location of plants as deemed necessary.
 - Landscape contractor shall provide all labor, materials and service necessary to furnish and install plantings as specified her in and as shown on these plans. All plant materials shall be protected from the drying action of the sun and wind after being dug, while being transported, and while awaiting planting. Balls of plants which cannot be planted immediately shall be protected from drying action by covering them with moist mulch. Periodically, apply water to mulch-covered root balls to keep moist. If planting should occur during growing season, apply anti-desiccant to leaves before transport to reduce likelihood of windburn. Reapply anti-desiccant after planting to reduce transpiration.
 - All plant material shall be well-formed and developed in good condition, healthy and disease-free, and be typical of the species. Plants shall comply in all applicable respects with acceptable standards as set forth in the American Association of Nurseryman's "American Standard of Nursery Stock." Owner and landscape architect reserve the right to reject at any time or place prior to final acceptance of work, any and all plants which, in their opinion, fail to meet these specification requirements.
 - Plants designated container grown shall have been grown in pots, cans or boxes for a minimum of six months and a maximum of two years. These plants shall be removed from containers before planting. Plants that appear root-bound shall be root pruned through the use of a vertical slicing method prior to planting.
 - Landscape contractor shall locate all utilities prior to starting work. Landscape contractor will be responsible for the repair of any damage caused to utilities.

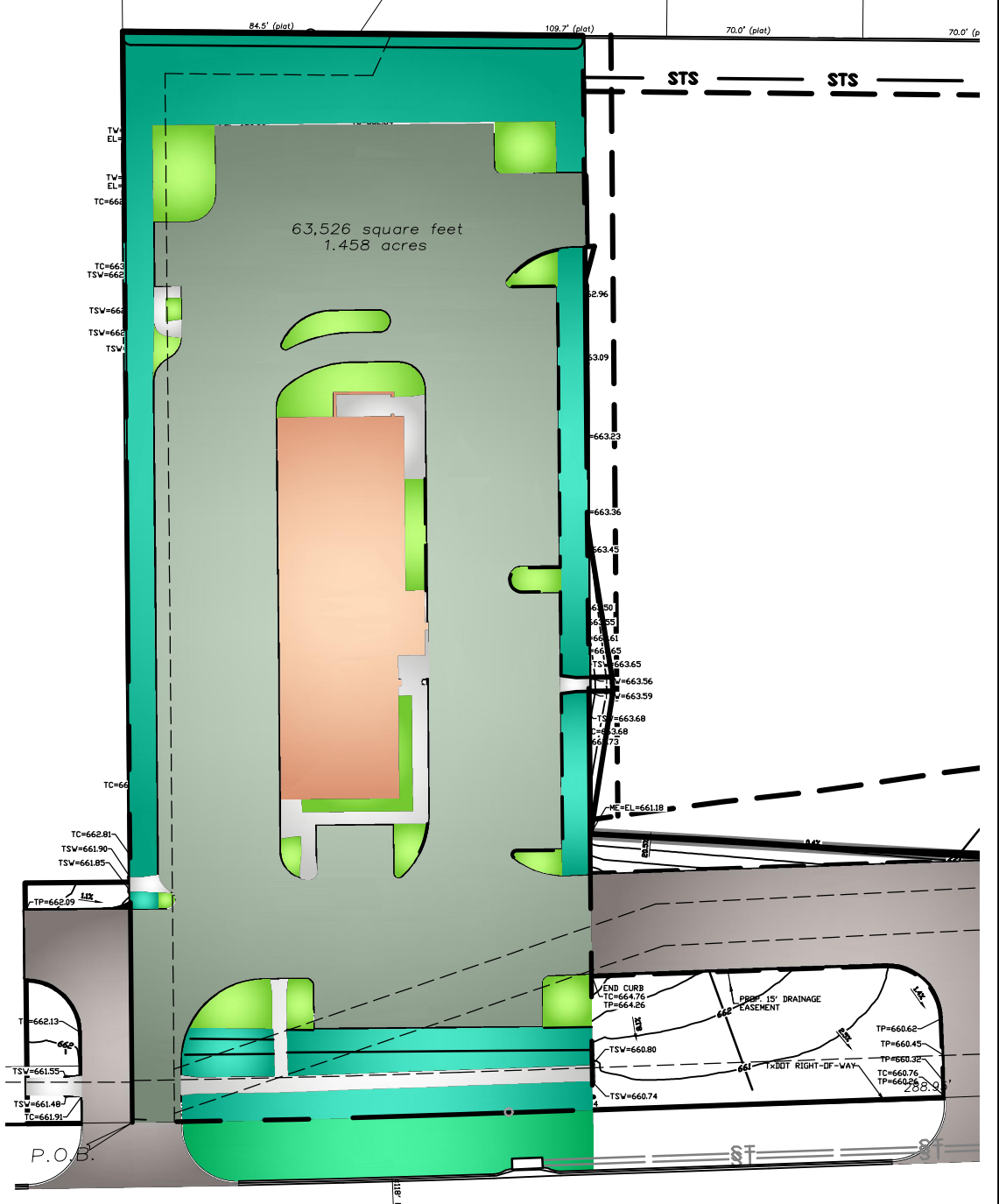

SITE DEVELOPMENT

SYMBOL	NOTES	QTY
	PARKING AREA	35,555 SF
	BUILDING	6,131 SF
	PARKING LOT LANDSCAPE	4,361 SF
	PERIMETER LANDSCAPE	13,932 SF
	OFF-SITE LANDSCAPE	3,008 SF
	WALKS	2,616 SF
	OFF-SITE PAVING	11,470 SF



Baughman Company, P.A.
315 E. S.W. 1st St., Suite 100, Fort Worth, TX 76102
P: 817.335.1111 F: 817.335.1112
www.baughmancompany.com
Landscape Architect
Professional Seal
Baughman
Greenway Keller, L.P.
LANDSCAPE PLAN
New Braun's Ice Cream and Dairy Store

- Detention area added, trees species changed in new basin area.
- 7-5-18 Detention area revised per civil, turf area increased.
- 8-20-18 Thornless Honeylocust for Live Oak.
- 8-24-18 Shrubs and columns moved 2' south to allow for a 2' vehicle overhang.

1" = 20'

